

### KEY FEATURES

- Robust construction suitable for indoor and outdoor applications
- Available with a 6ft pre-wired or quick disconnect cable
- Available with 100° flood or 30° narrow beam profile
- Designed for use in harsh and hazardous locations
- Thermally managed for maximum longevity



### TECHNICAL SPECIFICATIONS / MAXIMUM RATINGS

HOUSING	Anodized Aluminum
MOUNTING	Stainless Steel Yoke
VOLTAGE MAXIMUM	28 VDC
INPUT VOLTAGE	12-24 VDC
POWER (TYP)	31.6W @ 12 VDC   33.6 W @ 24 VDC
CURRENT (TYP)	2.64 A @ 12 VDC   1.4 A @ 24 VDC
CONNECTIONS	Turck MiniFast quick connect with 1.8 m (6ft) lead (Custom lengths available)
TEMPERATURE RANGE	-40°C to +45°C (Case ~20°C above ambient)
CERTIFICATIONS	Class I, Division 2, Groups ABCD, T3
INGRESS PROTECTION	IP66
COLOUR TEMP RANGE	50: 5000K   Special Order: 2700-6500K
CRI VALUE (MIN)	50: 70
TOTAL LUMENS	50-W: 1996   50-N: 2334
LUMEN MAINTENANCE	LM-80 > 60,500 hrs (Based on CREE long term testing)
WEIGHT	2.05 kg   4.5 lbs

### DIMENSIONS

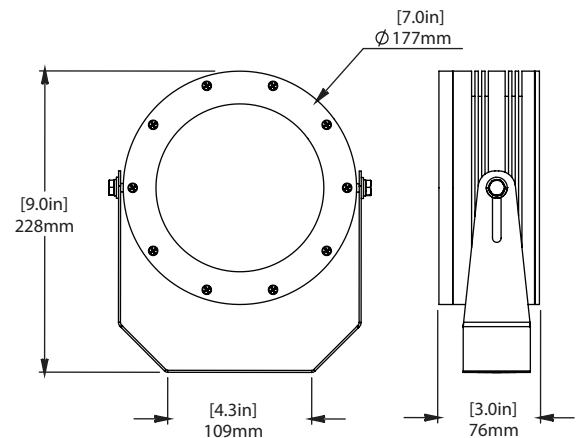

### WARRANTY

Five (5) year limited warranty to the original purchaser. The warranty covers defects in materials and workmanship under normal use and service.

For additional information see: <https://nemalux.com/legal>

### OPTIC OPTIONS

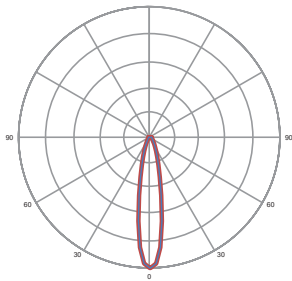

N - Narrow

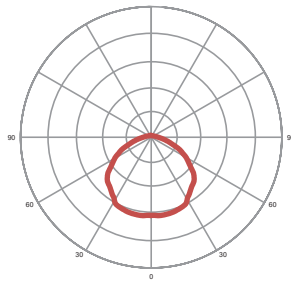

W - Wide

NARROW BEAM



WIDE BEAM



FROSTED LENS



### PHOTOMETRICS

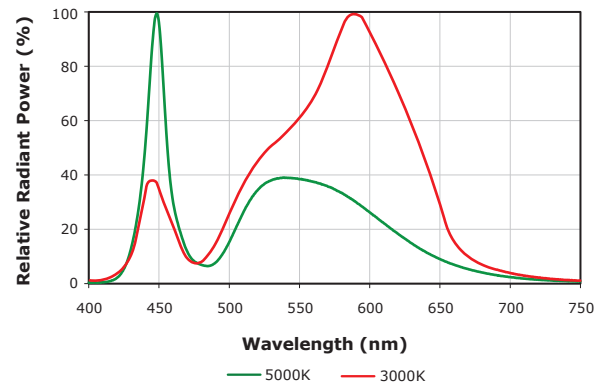

### MOUNTING

#### MOUNTING BRACKET

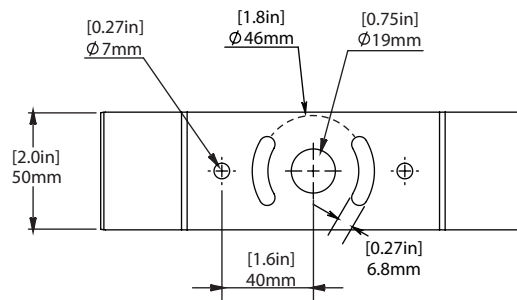
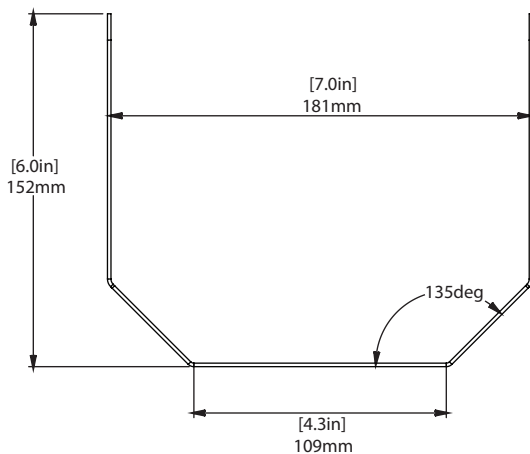

## ORDERING INFORMATION

PROJECT NAME		TYPE
PROJECT LOCATION		
COMMENT		DATE
PREPARED BY		

## MODEL SELECTOR

Sample Number: XCANLEDDC-50-WF-ALU-C1D2

MODEL	COLOUR	OPTIC	FINISH	LOCATION
XCANLEDDC -	-	-	ALU -	C1D2
	<b>50</b> - Cool White (5000K)  Special Order: <b>27</b> - 2700K <sup>1</sup> <b>30</b> - 3000K <sup>1</sup> <b>35</b> - 3500K <sup>1</sup> <b>40</b> - 4000K <sup>1</sup> <b>45</b> - 4500K <sup>1</sup> <b>50</b> - 5000K <sup>1</sup> <b>55</b> - 5500K <sup>1</sup>	<b>W</b> - Wide <b>WF</b> - Wide Frosted  <b>N</b> - Narrow <b>NF</b> - Narrow Frosted	<b>ALU</b> - Clear Anodized  Custom finishes are available. Please contact for details. <sup>1</sup>	<b>C1D2</b> - Hazardous Locations

## CUSTOM OPTIONS

### WIRING

Other wire lengths available in 30 cm (1 ft) increments.<sup>1</sup>

### NOTES:

1. Minimum order quantities, additional costs and lead times may apply.